



Torque Motor



I AND I INTERNATIONAL Co., LTD



dun & bradstreet
D-U-N-S® CERTIFIED



Alibaba
Trade Assurance Supplier

Principle of three-phase torque motor

The design of the torque motor is different from the general motor. The torque motor has a large starting rotation torque. It can obtain stable torque and rotation speed during low speeds or under constrained loads (reverse stable force). The torque is highest at zero speed (maximum continuous stall torque) and decreases steadily with increasing speed to keep motor and loading balanced. Motor rotation speed change is available by adjusting supply voltage when torque is constant. When the loading increases, the torque of the motor is proportional to the square of the voltage. When the torque is constant, the rotation speed can be changed by changing the supply voltage. The characteristics of the torque motor let it suitable to provide constant tension when continuous winding items, and also have continuous constant speed.

Feature

- ✓ Low starting current with high starting torque
- ✓ 3 Phase squirrel- cage motor with high reliability
- ✓ Torque motor can associate with controller for speed/ torque adjustment
- ✓ Heat dissipation well and long-term operation

Applications

- ✧ For winding (center winding or surface winding)
 - A. Fabric, bands made of plastic, rubber, fabric or paper.
 - B. Thread and wire: copper, iron and aluminum wire, insulating electric wire and plastic string.
 - C. Liquid material and mixer.
(PP&PE Monofilament making machine, Monofilament extrusion lines machine, blown film extruders machine, Slitting machine, circular loom.)
- ✧ Desizing machine; dyeing and printing fabrics
- ✧ Powerful crusher machine
- ✧ Load auxiliary, starting or brake, receiving and distributing material and compensator
- ✧ Used in braking, feeding devices and with cloth inspecting machines and lifters.

Motor No. of Pole Synchronous RPM & Torque

No. of Pole	Theoretical Speed in RPM		Actual Applied Speed in RPM	
	50Hz	60Hz	50Hz	60Hz
2	3000	3600	0~2000	0~2400
4	1500	1800	0~1000	0~1200
6	1000	1200	0~670	0~800
8	750	900	0~500	0~600
12	500	600	0~330	0~400

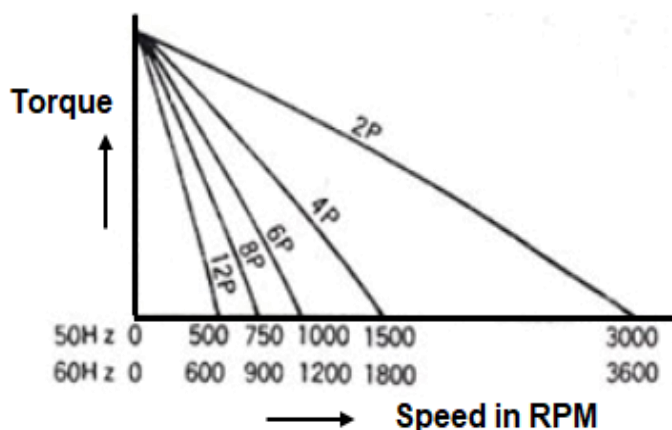

Horizontal Frame Torque Motor

➤ Frame 1

Torque Range : 1.2 ~2 KG-CM (Please sepcify the value you need)
Shaft length: Customize product(Please specifiy the value you need)

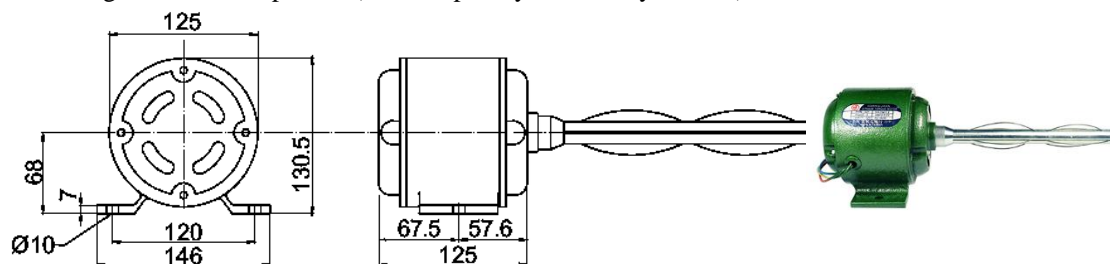

➤ Frame 2

Torque Range : 1.2 ~3 KG-CM (Please sepcify the value you need)
Shaft length: Customize product(Please specifiy the value you need)

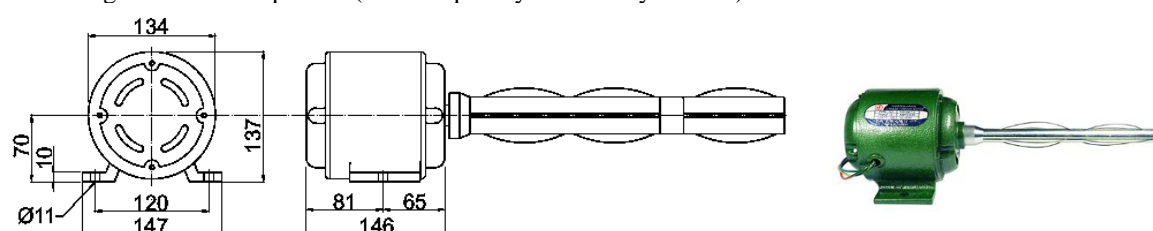

➤ Frame 2L

Torque Range : 1.2 ~5 KG-CM (Please sepcify the value you need)
Shaft length: Customize product(Please specifiy the value you need)

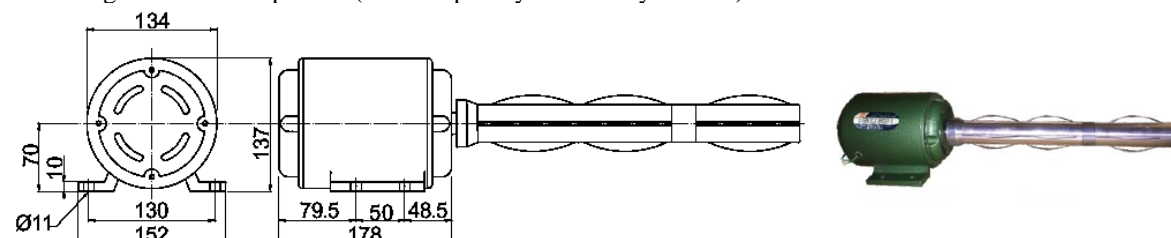

➤ Frame N2

Torque Range : 1.2 ~2.4 KG-CM (Please sepcify the value you need)
Shaft length: Customize product(Please specifiy the value you need)

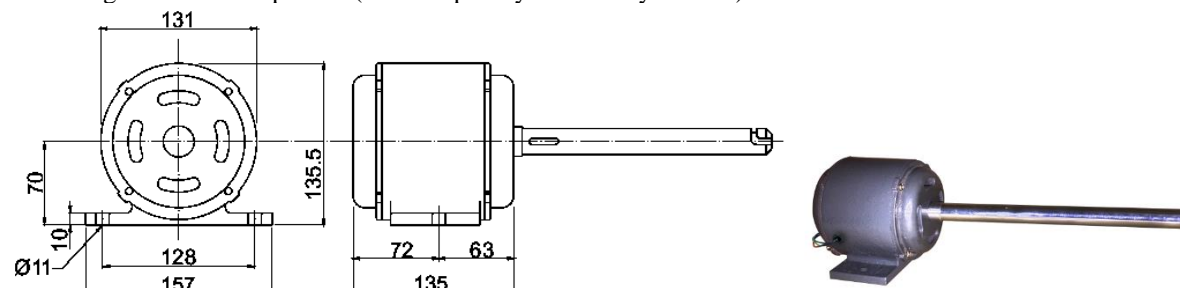

➤ Frame N3

Torque Range : 3 ~5 KG-CM (Please sepcify the value you need)
Shaft length: Customize product(Please specifiy the value you need)

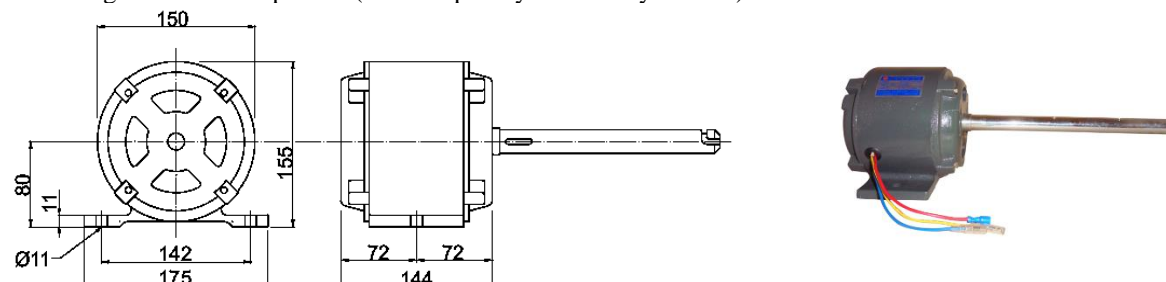

➤ **Frame N3L**

Torque Range : 3 ~7.5 KG-CM (Please sepcify the value you need)

Shaft length: Customize product(Please specify the value you need)

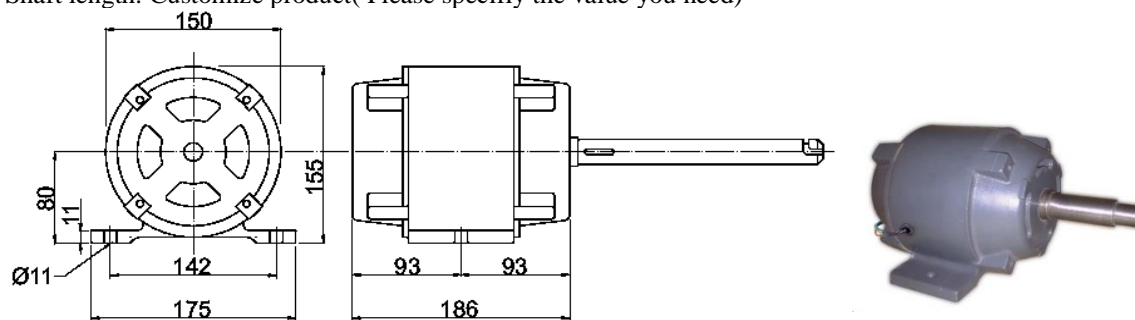

➤ **Frame 3 (No back fan)**

Torque Range : 5 ~10 KG-CM (Please sepcify the value you need)

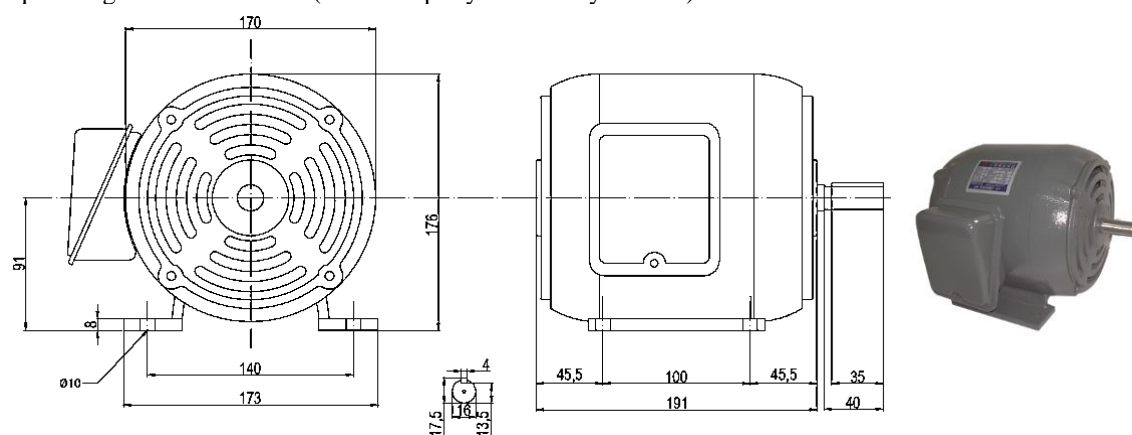

➤ **Frame 3 (With back fan)**

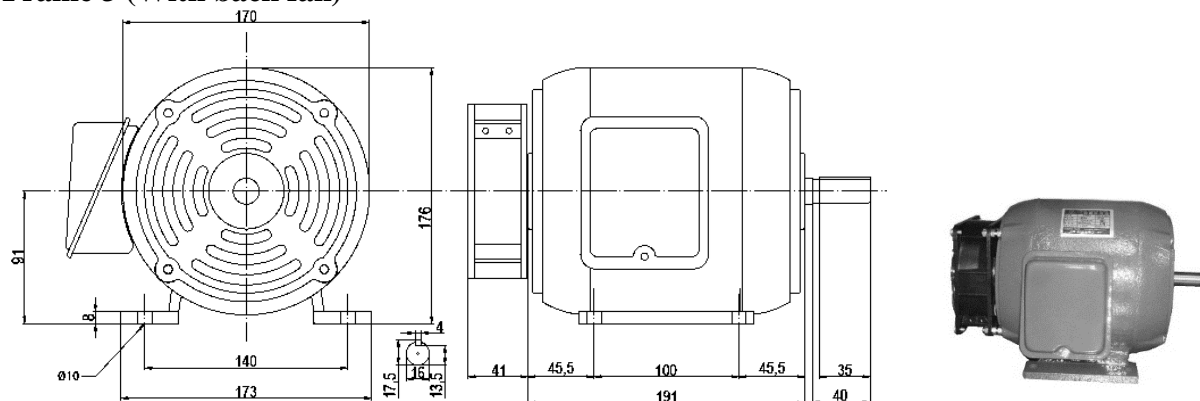

➤ **Frame 4**

Torque Range : 5 ~15 KG-CM (Please sepcify the value you need)

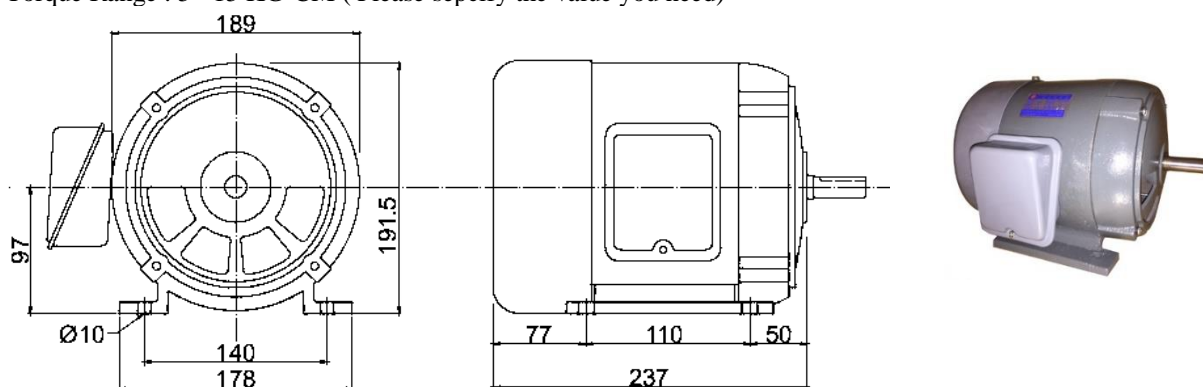

➤ **Frame 5F**

Torque Range : 5 ~20 KG-CM (Please sepcify the value you need)

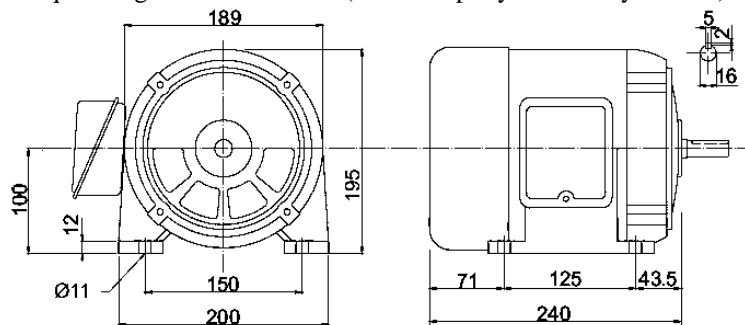

➤ **Frame 5**

Torque Range : 5 ~20 KG-CM (Please sepcify the value you need)

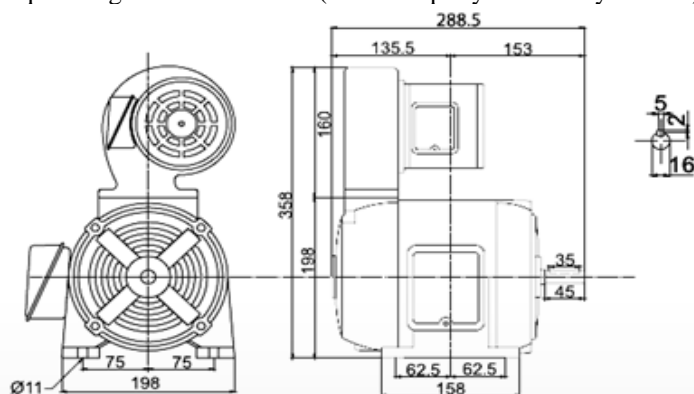

➤ **Frame 6**

Torque Range : 30 ~75 KG-CM (Please sepcify the value you need)

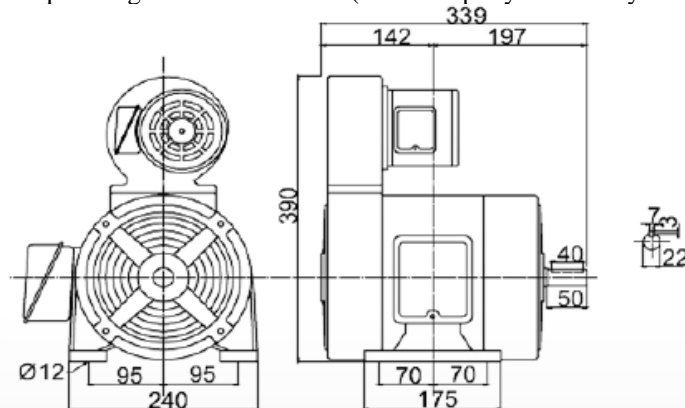

➤ **Frame 7**

Torque Range : 75 ~150 KG-CM (Please sepcify the value you need)

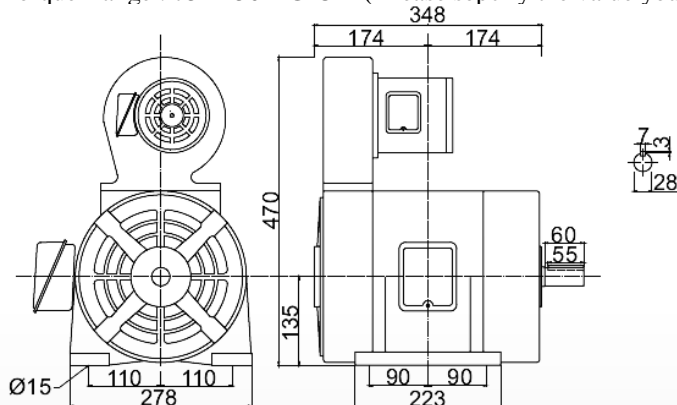

➤ Frame 8~11

Torque Range : 150 ~500 KG-CM (Please sepcify the value you need)

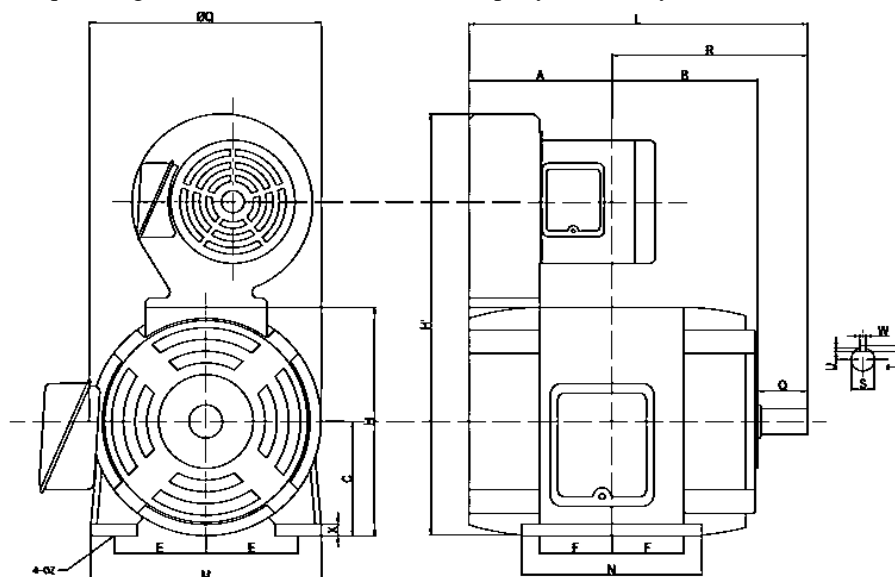

Reference KG-CM

框號	扭力 KG-CM		
Frame No.	4P	6P	8P
5	15/20		
6	30/40/50/75		
7	75	100	100

框號	扭力 KG-CM			本體尺寸(mm)												軸端尺寸(mm)							腳孔 (mm)
Frame No.	4P	6P	8P	A	B	C	D	E	F	H	H'	L	M	N	Q	R	S	T	U	W	Z		
8	100	150	150	175	175	136	268	110	70	270	470	380	280	190	60	225	28	7	4	7	12		
9	150	200	200	190	190	165	320	125	105	320	560	470	320	270	80	280	35	10	5	10	15		
10	200	300	300	210	210	165	320	125	125	320	560	510	320	310	80	300	35	10	5	10	15		
11	300	500	500	210	210	165	320	125	125	320	560	510	320	310	80	300	35	10	5	10	15		

Vertical Frame Torque Motor

➤ Frame A

Torque Range : 1.2 ~3 KG-CM (Please sepcify the value you need)

Shaft length: Customize product(Please specify the value you need)

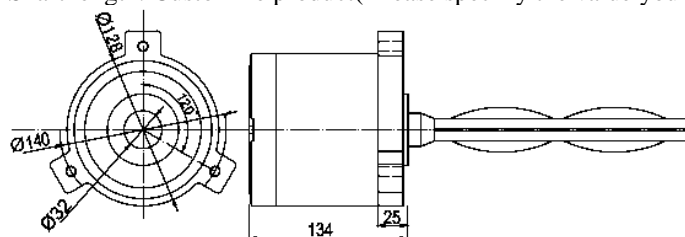

➤ Frame AL

Torque Range : 1.2 ~3 KG-CM (Please sepcify the value you need)

Shaft length: Customize product(Please specify the value you need)

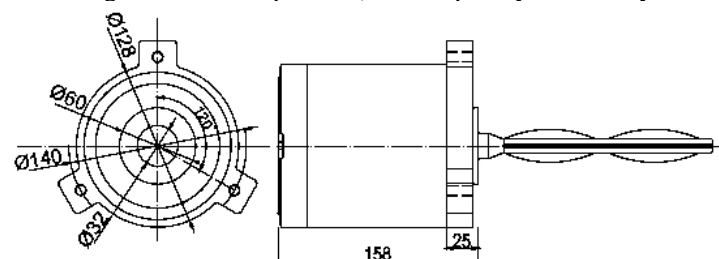

➤ **Frame NA**

Torque Range : 1.2 ~3 KG-CM (Please sepcify the value you need)
Shaft length: Customize product(Please specifiy the value you need)

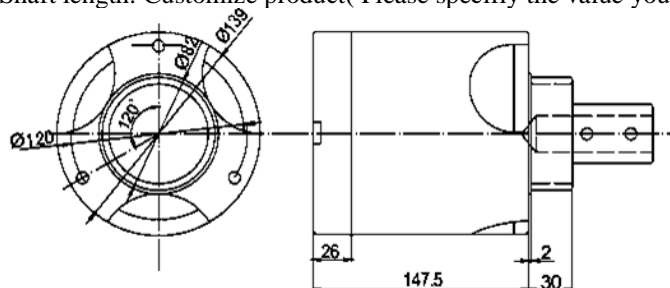

➤ **Frame B**

Torque Range : 5 ~10 KG-CM (Please sepcify the value you need)
Shaft length: Customize product(Please specifiy the value you need)

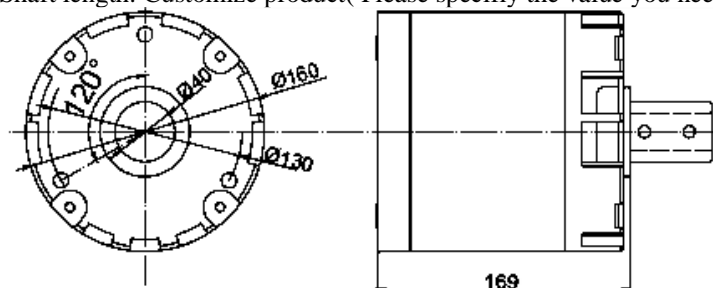

➤ **Frame CF**

Torque Range : 5 ~20 KG-CM (Please sepcify the value you need)

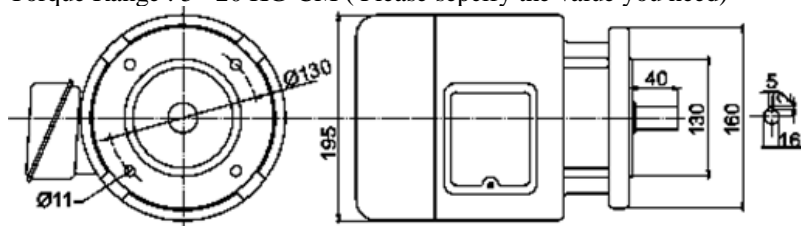

➤ **Frame C**

Torque Range : 5 ~20 KG-CM (Please sepcify the value you need)

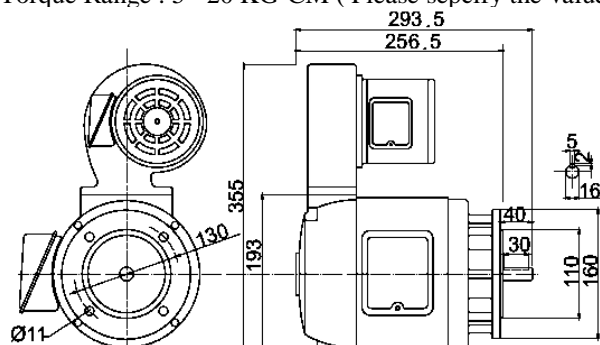

➤ **Frame D**

Torque Range : 30 ~75 KG-CM (Please sepcify the value you need)

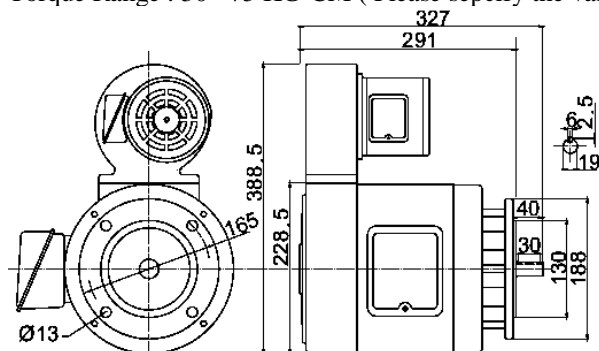

➤ **Frame E**

Torque Range : 75 ~ KG-CM (Please sepcify the value you need)



➤ **Frame F**

Torque Range : 30 ~75 KG-CM (Please sepcify the value you need)

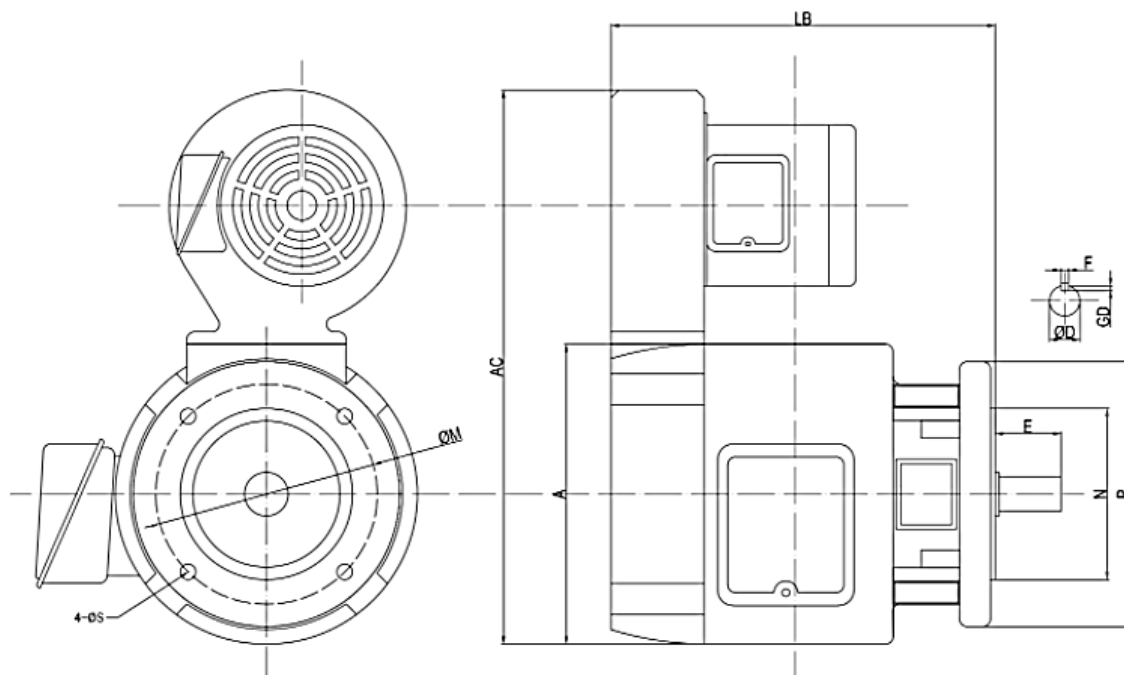
[illegible]

About Us

Group Organization

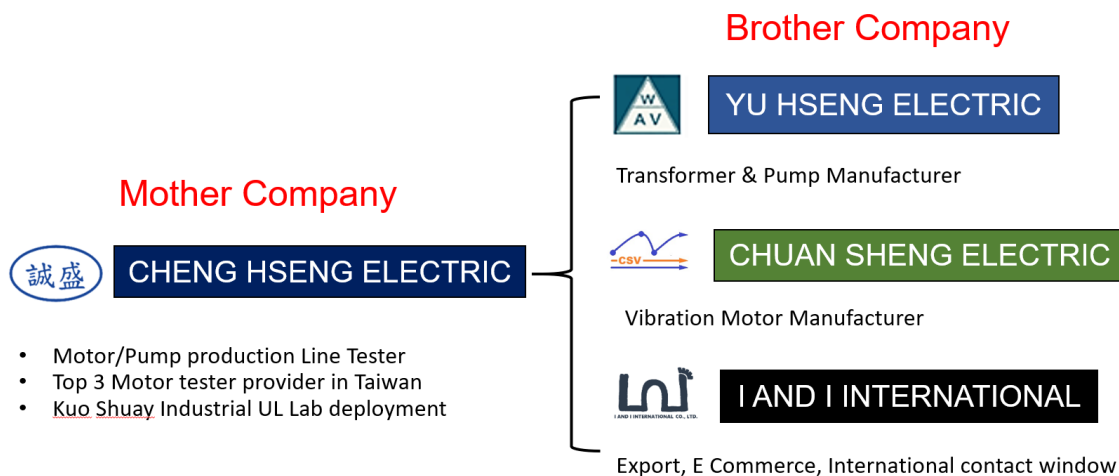

We, I AND I INTERNATIONAL CO. LTD. are introducing ourselves as an emerging supplier of industrial electric motors, transformers, and several other items. We have come here to offer the world-class Coolant Pumps, Vibrating Motor, Adjustable Transformers, Adjustable Voltage Transformer and other industrial machines. These machines are designed and developed as per the predefined industrial specification to ensure their high compatibility and quality. Additionally, we use high-grade steel and other material to ensure the sturdiness and long working of the products.

Established in the year 2016, we are working as a Manufacturer (Chuan Sheng Electric, Yu Hsheng Electric, and CHENG HSENG Electric), Exporter, and Supplier of industrial motors and transformers. Our unmatched quality keeps us apart from other manufacturers and have helped us create our brand value in the market. Our all products are verified by CE for their functionality and reliable usage. Further, to control and manage all business operations, we have an experienced team of employees which works round the clock and perform their duties very well.

Contact US

Web: <http://www.iniint.com>

Add: No.6, Aly. 3, Ln. 130, Xizhou Rd., Taiping City, Taichung County 411 Taiwan

TEL: 886-4-22780686 FAX: 886-4-22753287

Email: iniint.sales@gmail.com Email: yen@iniint.com Email: stella@iniint.com

 宇晴國際
Light up Business
Bridge to Global
I AND I INTERNATIONAL



 昱盛電機
YU HSENG ELECTRIC

 宇晴國際
Light up Business
Bridge to Global
I AND I INTERNATIONAL

 川盛
CHUAN SHENG VIBRATION MOTOR

 誠盛 誠盛電機
CHENG HSENG ELECTRIC